

Longitudinal cutting manual slitter LCM225MA

Optional accessorie LCU KAM-225 (SOLD SEPARATELY)

- working width 2250 mm -

Manual slitter with integrated housing frame.

Designed for the longitudinal cutting of conveyor belts.

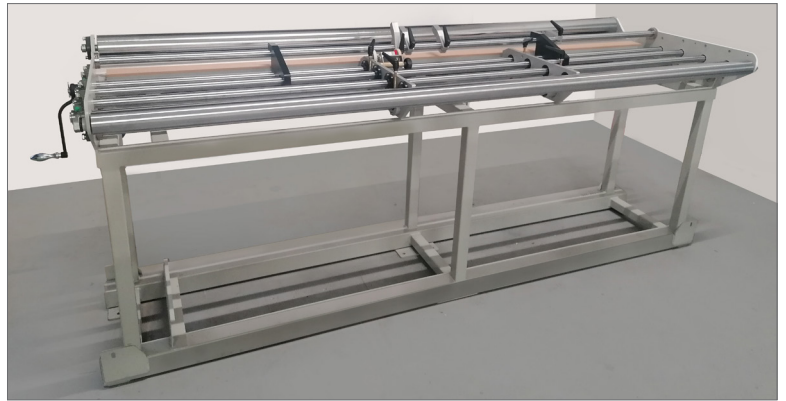

- Operated through manual drive of belt.
- Reduced size, easy to place.
- Maximum belt width: **2250 mm**. Minimum cut width: 100 mm.
- Permits cutting of belts up to 9 mm thick.
- Convertible to automatic slitter LCM225EEN.

In case of automation with the extension of the winder and unwinder, please refer to the LCM225EEN data sheet for further specifications.

SPECIFICATIONS:

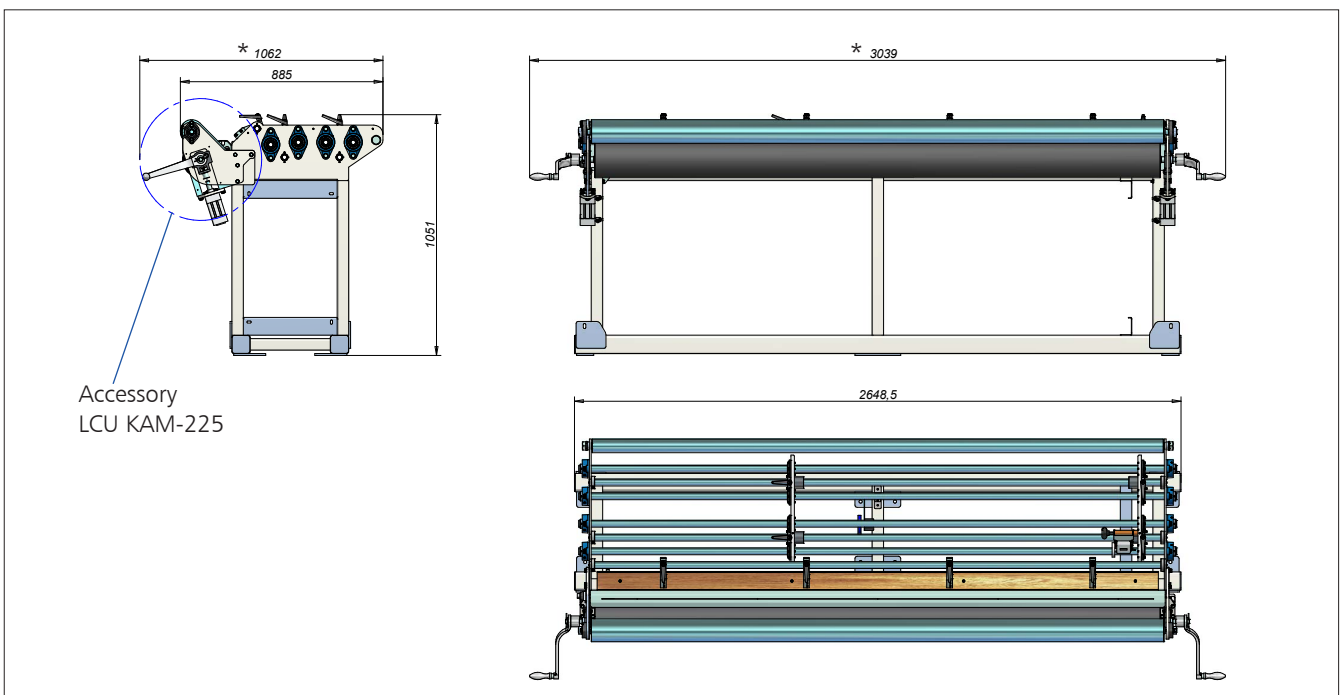

Width mm	Length mm	Height mm	Weight Kg
2648,5	885	1051	410

Data without accessories.



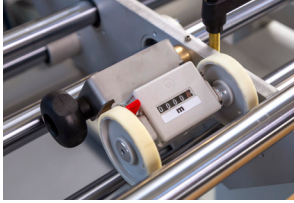

*Measurement including optional accessory LCU KAM-225.

Longitudinal cutting manual slitter LCM225MA

CHARACTERISTICS:	BENEFITS:
<p>Central cutting zone, with revolving idler system. Adjustable guides.</p> 	<p>Facilitate threading of the belt and ensure belt tightness. Prevent sideways movement of the belt and ensure a clean, straight cut at a constant width.</p>
 <p>Mechanical metre counter.</p>	<p>Length of cut can be checked at all times.</p>
 <p>4 blade holders with 20 trapezoidal spare blades.</p>	<p>Permits four cuts to be carried out. Simple, clean and effective cut. No traction required in the cutting zone, unlike circular slitters. Easy to position.</p> 

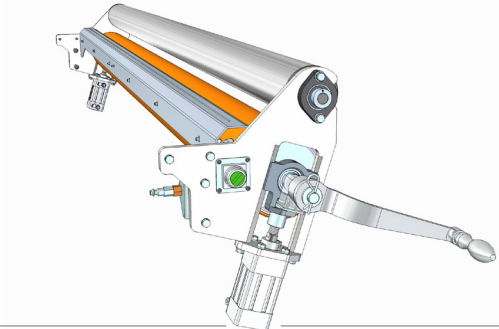
Accessory LCU KAM-225 *SOLD SEPARATELY*

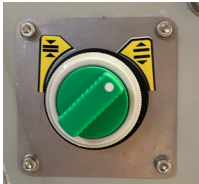
CHARACTERISTICS:	BENEFITS:
<p>Optional mechanism that can be added to the slitter, with a handle to advance the belt smoothly and continuously. It also considerably reduces manual effort.</p> 	<p>Facilitates the advancing of the belt. Permits belts to be cut with just one operator. Guide to facilitate crosswise cutting of the belt.</p> 
<p>Switch on the control panel in case the optional accessory LCU-KAM-225 is to be added to the slitter.</p> 	<p>The control panel is equipped with this switch by default such that when the LCU-KAM-225 mechanism is acquired later on, it could be easily added to the slitter without having to modify the electrical installation.</p>

